

Quick Start Guide

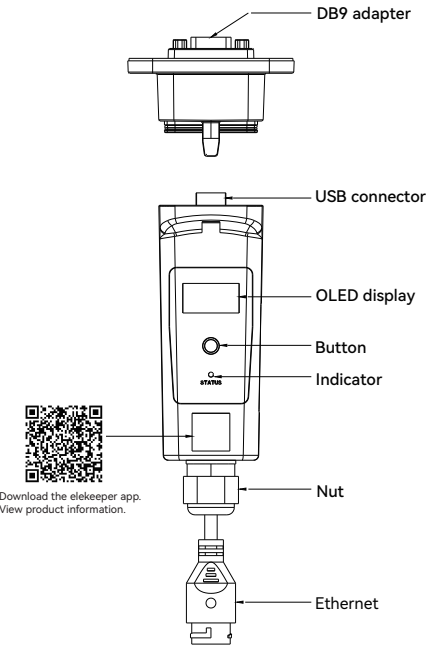

Indicator	Status	Description
Green (Ethernet)	Slow blink	The Ethernet connection is working.
	Fast blink	The firmware is upgrading.
	Solid	The module is not connected to the server.
Blue (Wi-Fi)	Off	No power supply or a program fault occurs.
	Slow blink	The WiFi connection is working.
	Fast blink	The Bluetooth is connected.

Table 1. Description of indicator status

**Note:**  
- Slow blink: 1s on, 1s off  
- Fast blink: 200ms on, 200ms off

1. Button Operations

The module provides a button for users to set the safety standards, check power generation information, fault information, and so on. The following table describes the supported operations.

Operation	Function
Single click	Select the previous or next page.
Double click	Return to the home page.
Long press	Confirm the operation.

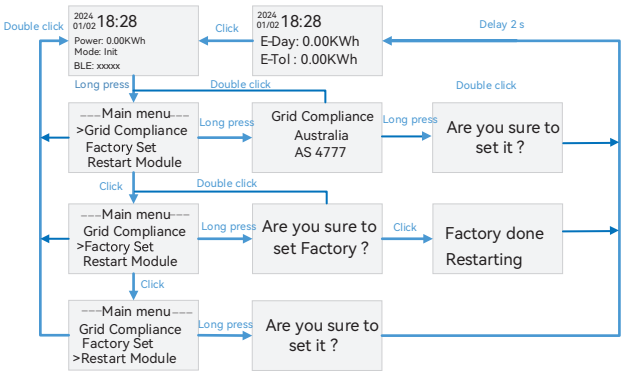

The screen will return to the home page if no further operation is performed for 40 seconds. The OLED monitor will turn off if no further operation is performed for 50 seconds.

2. Installation and Disassembly

2.1 Install and disassemble the module (USB port)

Install the module

- ① Open the cover of the 4G/WIFI communication port on the inverter.
- ② Insert the communication module to the port.

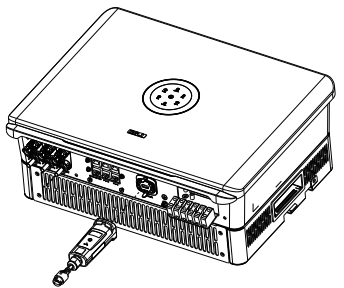
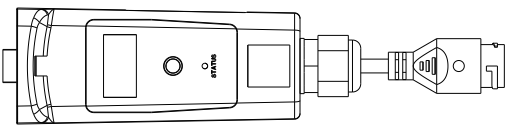

Disassemble the module

Unplug the communication module from the inverter.

2.1 Install and disassemble the module (DB9 port)

Install the module

- ① Insert the communication module into the inverter's communication port (RS-232/WIFI).
- ② Use two screws to secure the module on the inverter.

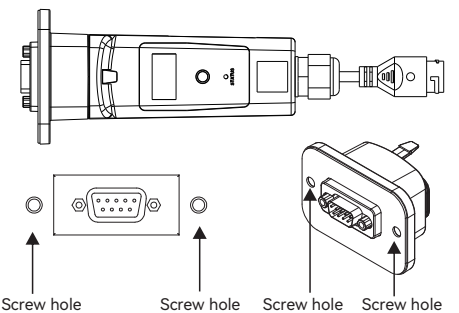

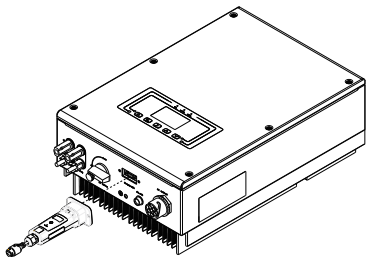

### Disassemble the module

Use a screwdriver to remove two screws and unplug the communication module from the inverter.

## 2. Commissioning

### 2.1 Verify module installation

After installing the module, power on the inverter and wait for two minutes. If the module signal light is blinking slowly as described in Table 1, it means that the module is working properly.

### 2.2 Install and log in to the app

- ① On your mobile phone, search for “elekeeper” in the app store.
- ② Download and install the App.
- ③ Open the app and tap the three-dot icon ... at the top right corner. Select the language and network node based on your installation site.
- ④ Log in with your account and password. If you do not have an account, register a new account and log in.

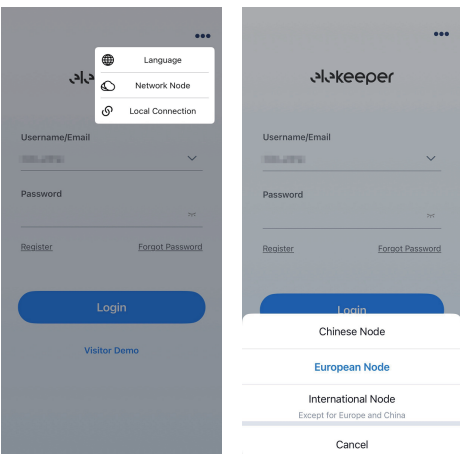

### 2.3 Configure the module

- ① Enable the Bluetooth function on your mobile phone.
- ② On the **Home** or **Service** page of the app, select **Remote Configuration**. Tap **Bluetooth** and then **Next Step**.
- ③ Select the BlueLink of the module, for example, BlueLink:00111.
- ④ Select the network connection mode, and configure the corresponding parameters for the selected mode. For Ethernet, ensure that the Ethernet cable is connected to the router.

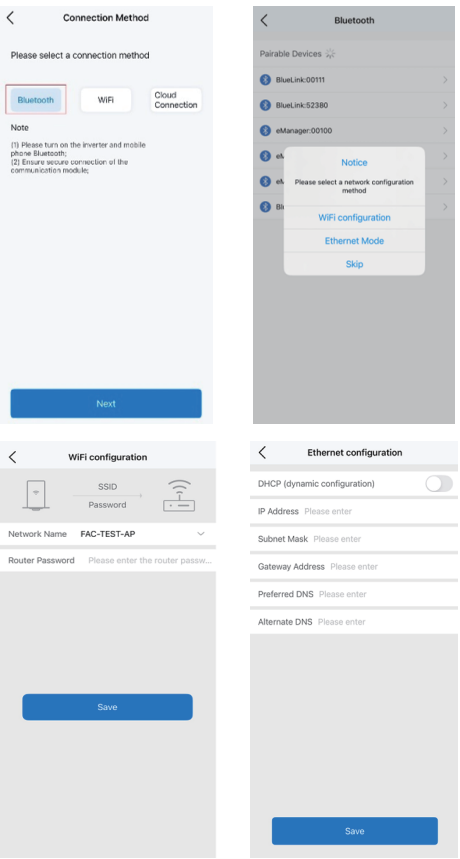

- ⑤ On the **Device List** page, tap the module to view the details of the module.
- ⑥ On the details page of the module, tap the settings icon at the upper right corner to change the configurations of the module.

