

## Quick Installation Guide

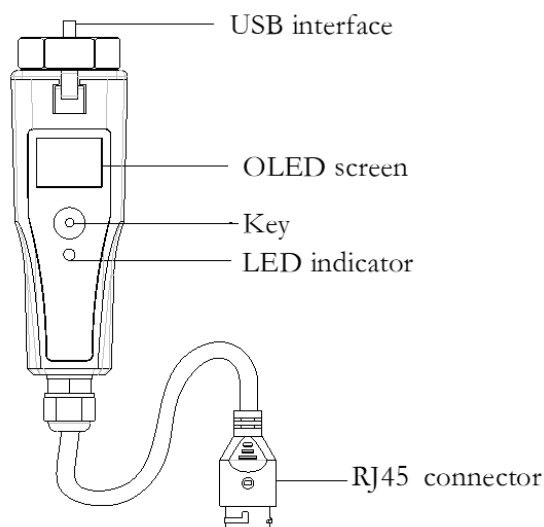

Download the elekeeper app.  
View product information.

## 1. LED Indicators and OLED Screen

### LED Indicators

Indicator	Status	Function Description
Green (Ethernet)	Slow blink <sup>1</sup>	The Ethernet connection is working.
	Fast blink <sup>2</sup>	The firmware is upgrading.
	Solid	The module is not connected to the server.
	Off	No power supply or a program fault occurs.
Blue (Wi-Fi)	Slow blink	The WiFi connection is working.
	Fast blink	The Bluetooth is connected.

Table 1 Description of the LED indicator on the module

1: Slow blink (1s on, 1s off)  
2: Fast blink (200ms on, 200ms off)

Indicator	Status	Function Description
Green	Blinking	The module is sending data to the router.
	Solid	The module is connected to the router.
	Off	The module is not connected to the router.

Table 2 Description of the LED indicator on the RJ45 connector

### OLED Screen

Use the key under the OLED screen to set the safety standards, check power generation information, fault information, and so on.

The following table describes the key operations:

Operation	Function Description
Single click	Select the previous or next page.
Double click	Return to the home page.
Long press	Confirm the operation.

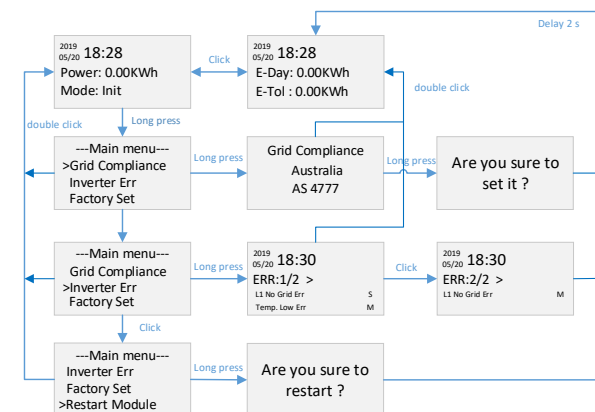

The screen will return to the home page if no further operation is performed for 40 seconds. The OLED monitor will turn off if no further operation is performed for 50 seconds.

## 2. Installation

- 1) Turn the hexagon nut of the module to a horizontal position.

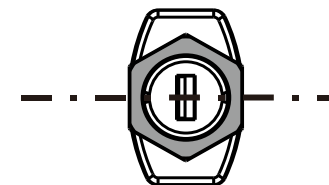

- 2) Insert the module into the inverter's USB interface and fasten the hexagon nut clockwise.
- 3) Connect the RJ45 connector to the router.
- 4) After installing the module, power on the inverter and wait for two minutes. If the module signal light is blinking slowly as described in Table 1, it means that the module is working properly.

## 3. Commissioning

### 3.1 Install and log in to the app

- 1). On your mobile phone, search for "elekeeper" in the app store.

- Download and install the App.
- Open the app and tap the three-dot icon **•••** at the top right corner. Select the language and network node based on your installation site.
- Log in with your account and password. If you do not have an account, register a new one and log in.

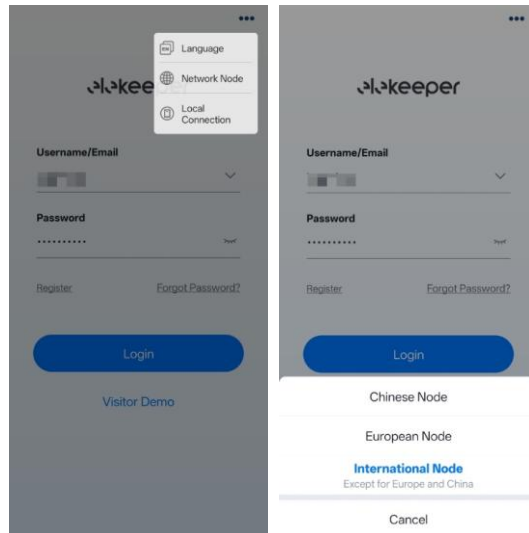

### 3.2 Configure the module

- Enable the Bluetooth function on your mobile phone.
- On the **Home** or **Service** page of the app, select **Remote Configuration**. Tap **Bluetooth** and then **Next Step**.
- Select the BlueLink of the module, for example, BlueLink:00012.
- Select the network connection mode, then configure the corresponding parameters for the selected mode.  
For Ethernet, ensure that the Ethernet cable is connected to the router.

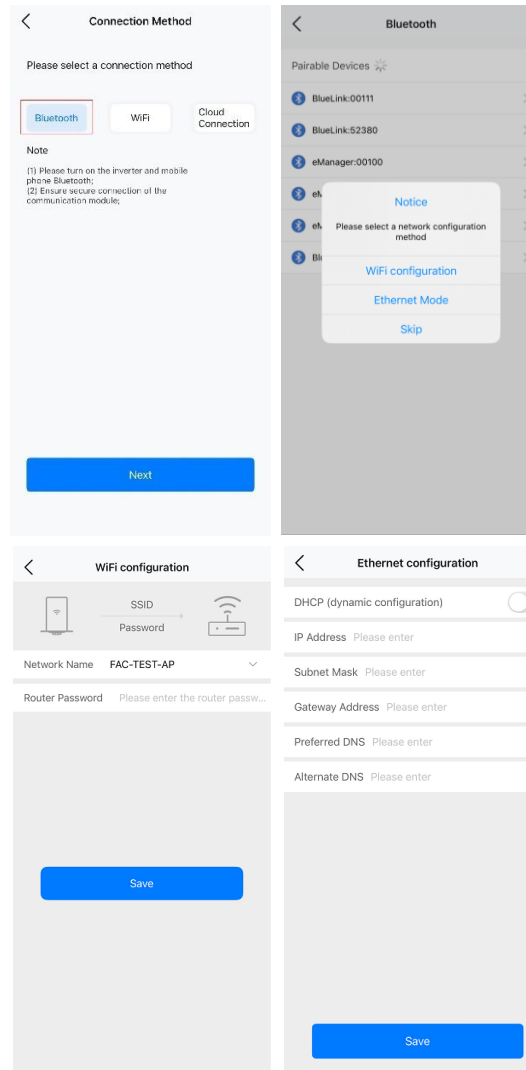

- On the **Device List** page, tap the module to view the details of the module.

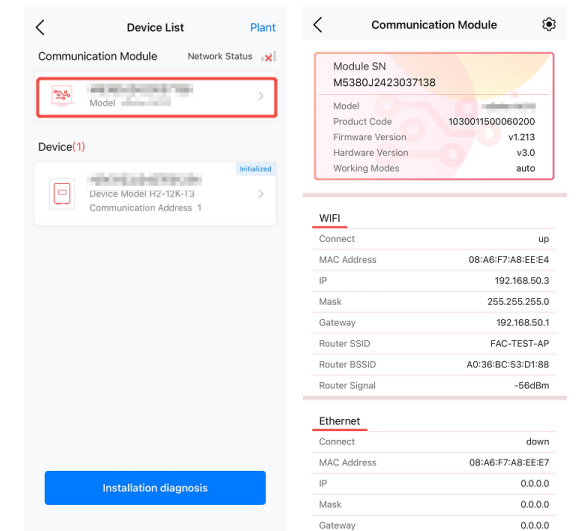

- On the details page of the module, tap the settings icon at the upper right corner to change the configurations of the module.

